

# Firmamento Milano

## Luna (∅ 30)

Carlo Guglielmi

Plafone / Ceiling

Parete / Wall

La sorgente luminosa di questo apparecchio deve essere sostituita esclusivamente dal produttore o dal suo servizio assistenza o da personale qualificato equivalente

The light source contained in this luminaire shall only be replaced by the manufacturer or a similar qualified person

**Watt** 20 W

**Led** 220 / 240V

**IP** 20

**Cl** I



1

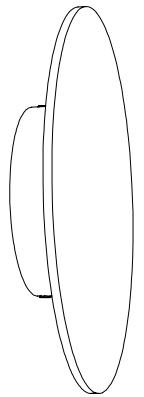
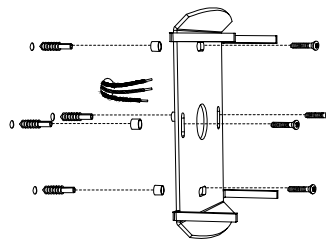
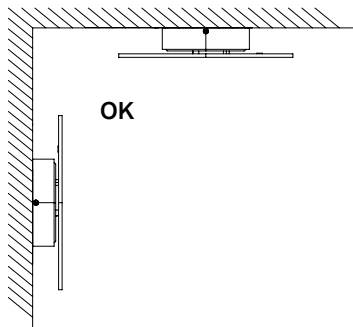
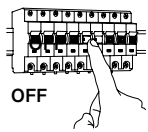

2

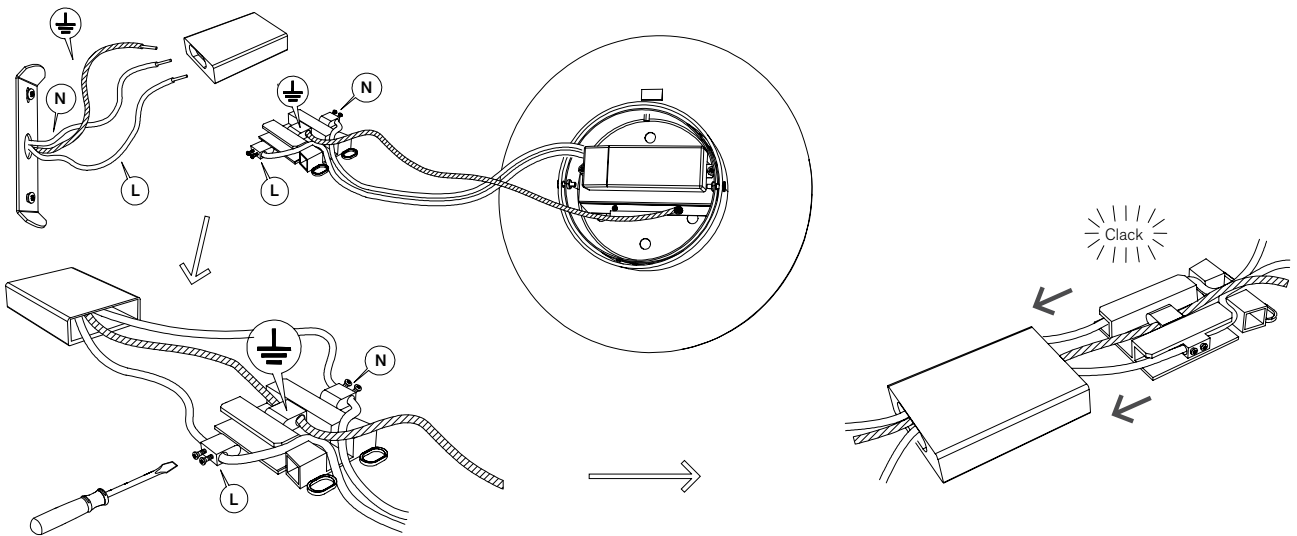

3

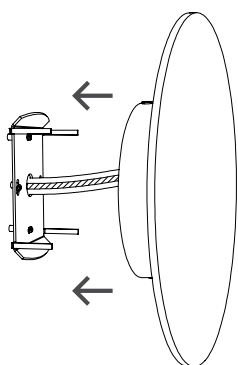

4

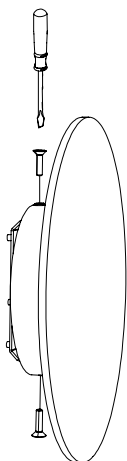

5

Luna Tonda

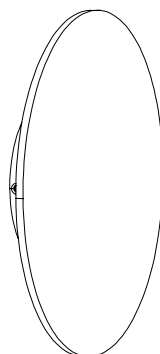

Luna Quadra

